

4 tool tie tamper attachment



Features

Track maintenance at railroad points and crossing by using a road-rail power shovel

- Tamping at railroad points and crossing can be performed at a high working efficiency by installing the attachment to a road-rail power shovel.
- Sufficient tamping effect can be obtained with the aid of the machine vibration, hydraulic power and special tie tamper teeth.
- Provided with a rotator, with which tamping of adjacent tracks can be performed.
- A road-rail power shovel can be used for various purposes, thereby reducing the operating time.



Examples of work



Outline of construction

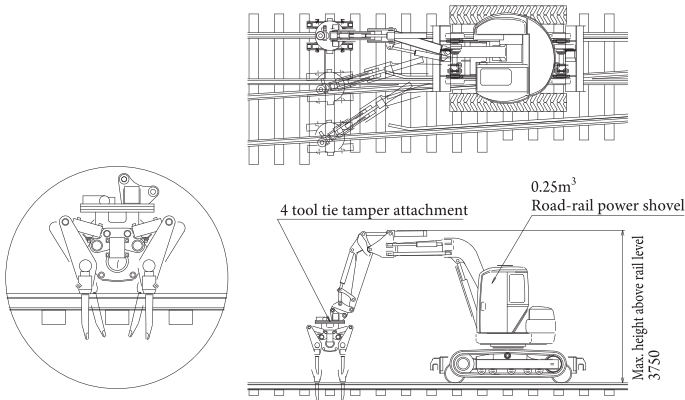

Major dimensions

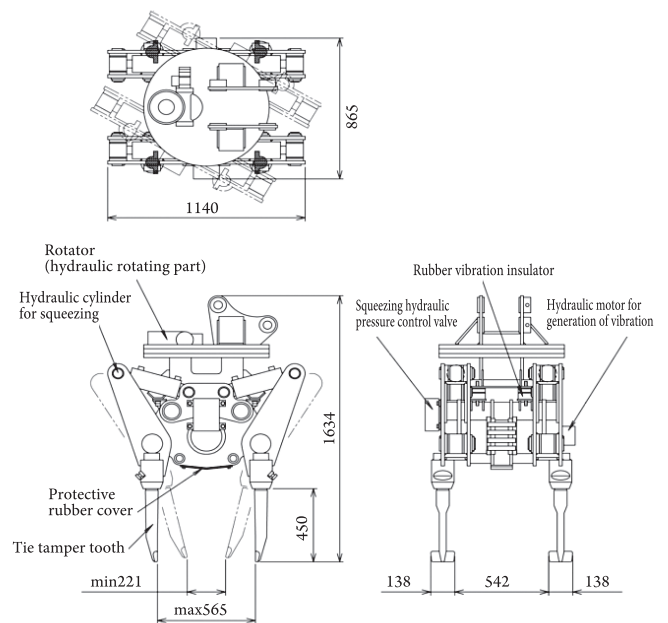

Principal specifications

Item	MTPA040H
Specifications	
Overall length X width X height (mm)	1,140×865×1,635
Total weight of body (kg)	1,300
Construction method	Tamping of sleepers one by one under one of rails
Max. tamping depth (mm)	Approx. 250 deep from underside of sleeper
Vibration force (N)	34,000
Vibration frequency (Hz)	30~35
Amplitude (mm)	3.0
Min. required amount of oil (ℓ/min)	35+50
Max. working hydraulic pressure (kgf/cm ²)	210
Applicable heavy equipment	Road-rail power shovel(applicable class: 0.25m ³)